

# AV5A Air Admittance Valve With Couplings



The AV5A is manufactured in aluminum alloy. It has a control knob attached to a screw-actuated plunger: turn the control knob clockwise to close the valve. A nitrile 'O' ring seals the plunger to the valve body.

The valve can be connected directly, pipeline supported or panel mounted, and is connected to the vacuum system with the Edwards SC5 coupling (supplied).



## Dimensions

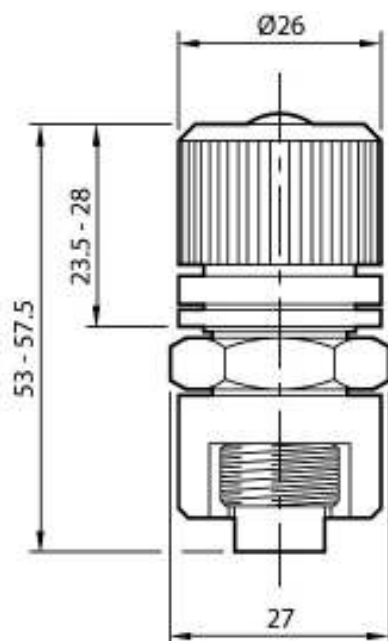

## Technical Data

### Materials of construction

Body	HE30 aluminum / nickel plated brass
Plunger	HE30 aluminum
Seal	Nitrile
Leak rate across seat	$10^{-7}$ mbar ls <sup>-1</sup> / $8 \times 10^{-8}$ Torr ls <sup>-1</sup>
Leak rate through body	$10^{-1}$ mbar ls <sup>-1</sup> / $8 \times 10^{-2}$ Torr ls <sup>-1</sup>
Panel mounting	Ø 17 mm / Ø 0.66 in hole, 3 mm / 0.117 in maximum thickness
Vacuum connections	SC5 couplings or 3/8 inch BSP threaded body and bonded seal
Weight	85 g / 3 oz

5

Page  
193

## Ordering Information

Product Description	Order No.
AV5A Air Admittance Valve With Couplings	C35003000
Accessories & Spares	Order No.
O Ring Nitrile Vor 2A Pk 10	H02105115
Dowty Seal 3/8 BSP MkC	H02104003

# AV10K Air Admittance Valve



The AV10K is manufactured in aluminum alloy. It has a control knob attached to a screw-actuated plunger: turn the control knob clockwise to close the valve. A nitrile 'O' ring seals the plunger to the valve body.

The valve can be pipeline supported only, and is connected to the vacuum system with an NW10 fitting.

## Dimensions

## Technical Data

5

Page  
194

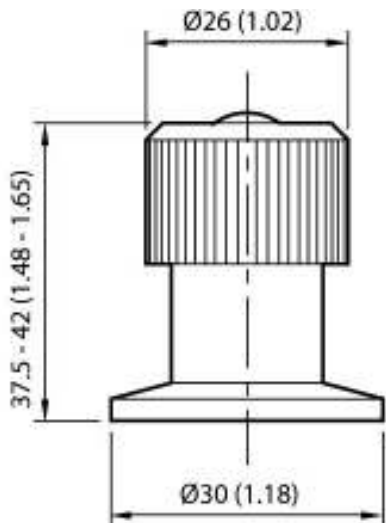

### Materials of construction

Body	HE30 aluminum
Control knob	Nylon 6
Seal	Nitrile
Leak rate across seat	$10^{-7}$ mbar ls <sup>-1</sup> / $8 \times 10^{-8}$ Torr ls <sup>-1</sup>
Leak rate through body	$10^{-1}$ mbar ls <sup>-1</sup> / $8 \times 10^{-2}$ Torr ls <sup>-1</sup>
Vacuum connections	NW10
Weight	100 g / 3.5 oz

## Ordering Information

Product Description	Order No.
AV10K Air Admittance Valve	C35103000
Accessories & Spares	Order No.
O Ring Nitrile Vor 2A Pk 10	H02105115

# IPVA10EK Air Admit Valve



The IPVA10EK is a solenoid operated valve designed for automatic admittance of air or vent gas into a vacuum system. The valve has two ports with NW flanges. One of the valve ports is connected to the vacuum system, the other port can be left open to atmosphere or connected to a vent gas supply. The vacuum system is isolated from atmosphere (or the vent gas supply) by a fluoroelastomer pad on the base of the valve plunger, which seals against the body of the valve.



## Features & Benefits

- Normally open or normally closed option.
- Small envelope
- IP65 protection
- MTTF 100000 Cycles

## Dimensions

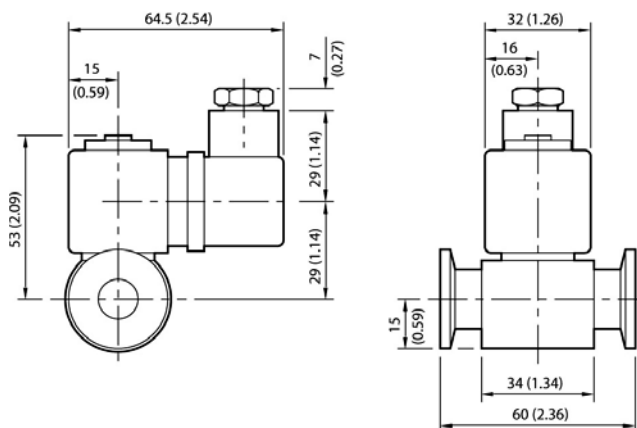

5

Page  
195

## Technical Data

Operating temperature range	-20 to 55 °C
Vent gas temperature range	-10 to 130 °C
Venting rate	10 litres in 12 s
Response time	30 ms
Maximum cycle frequency	100 min <sup>-1</sup>
Reliability (MTTF)	10 <sup>5</sup> cycles
Leak rate	1 x 10 <sup>-9</sup> mbar ls <sup>-1</sup> / 8 x 10 <sup>-10</sup> Torr ls <sup>-1</sup>
Electrical supply	110V or 240V a.c. 1-ph, 50/60 Hz or 24V d.c.
Tolerance	
a.c.	-10% to +10%
d.c.	-5% to +10%
Power	
a.c.	9.3 VA inrush 6.3 VA hold
d.c.	5W
Enclosure rating	IP65
Weight	310 g / 11 oz
Materials of construction	
Body	Aluminium
Valve seal	Fluoroelastomer
Actuator	Stainless steel
Coil insulation	Class F

The air or vent gas path through the valve is free from heavy metals.

## Ordering Information

Product Description	Order No.
IPVA10EK, 240 V a.c. (normally open)	C41721000
IPVA10EK, 110 V a.c. (normally open)	C41722000
IPVA10EK, 24 V d.c. (normally open)	C41723000
IPVA10EK, 240 V a.c. (normally closed)	C41731000
IPVA10EK, 110 V a.c. (normally closed)	C41732000
IPVA10EK, 24 V d.c. (normally closed)	C41733000

# LV10K Leak Valve NW10 Flanges



The LV10K needle valve provides fine control of gas bleed into a vacuum chamber or a regulated leak to control pressure in a vacuum system and is suitable for gas admission down to  $10^{-5}$  mbar /  $8 \times 10^{-6}$  Torr. Suitable for pipeline or panel mounting.

## Dimensions

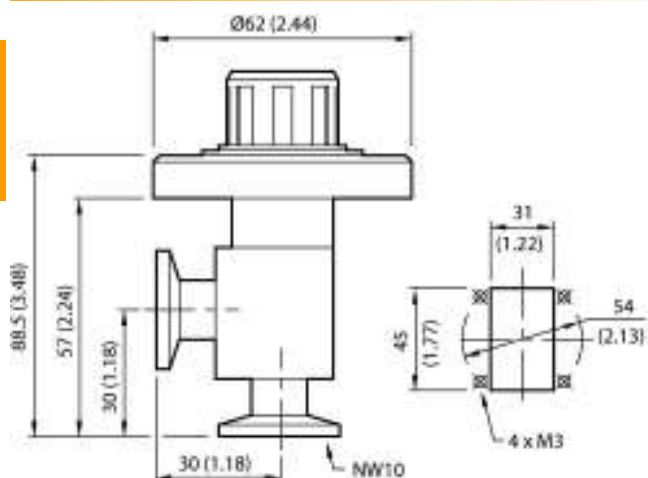

## Technical Data

### Materials of construction

Body	Aluminium HE30
Seat	Brass BS2784 C2112
Needle	Martensitic stainless steel EN56AM
Filter	Brass BS249
Max flow rate (approx)*	$0.1 \text{ ls}^{-1}$
Max inlet pressure	2000 mbar / 1500 Torr
Max leak rate, across seat	$10^{-7} \text{ mbar ls}^{-1} / 8 \times 10^{-8} \text{ Torr ls}^{-1}$
Max leak rate, across body	$10^{-7} \text{ mbar ls}^{-1} / 8 \times 10^{-8} \text{ Torr ls}^{-1}$
Vacuum connection	NW10
Weight (g/oz)	138 g / 4.8 oz

\* Flow rate relates to a pressure differential across valve of one bar.

## Ordering Information

Product Description	Order No.
LV10K Leak Valve NW10 Flanges	C37102000
Accessories & Spares	Order No.
Spares Kit Valve Seat	C37102812