

# CG16K dial gauge



Edwards CG16K capsule dial gauges are barometrically compensated with NW flange fittings. Designed to cover the range of 0 to 1040 mbar, these robust gauges provide accurate, repeatable performance even at low pressures making them equally suited for non-corrosive process plant or for laboratory applications. Fitting is simple: the gauges can be mounted direct or panel mounted using the kit supplied.



## Features & Benefits

- Reading independent of gas type
- Accurate to  $\pm 2\%$  of full scale
- Barometrically independent
- Pipeline or panel mounting
- Easy to read linear scale

## Dimensions

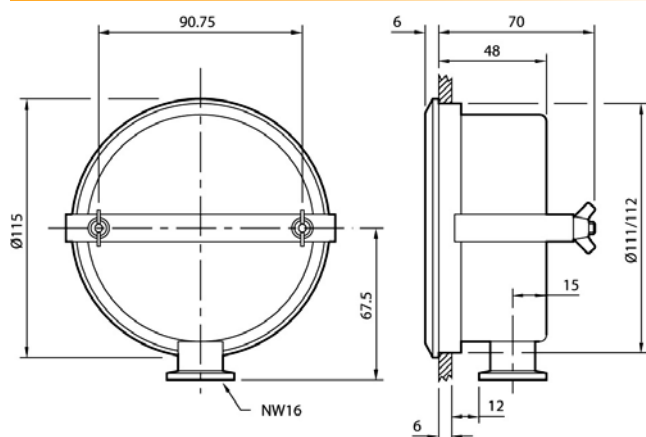

## Applications

- Backfilling
- Portable equipment
- Degassing
- Refrigeration
- Flammable vapors

## Ordering Information

Product Description	Order No.
CG16K, 0-1040 mbar	D35610000
CG16K, 0-125 mbar	D35611000
CG16K, 0-50 mbar	D35612000
CG16K, 0-25 mbar	D35613000
CG16K, 0-760 Torr	D35630000
CG16K, 0-100 Torr	D35631000
CG16K, 0-40 Torr	D35632000
CG16K, 0-20 Torr	D35633000
CG16K, 0-1040 mbar, Certificated	D3561000C
CG16K, 0-125 mbar, Certificated	D3561100C
CG16K, 0-50 mbar, Certificated	D3561200C
CG16K, 0-25 mbar, Certificated	D3561300C
CG16K, 0-760 Torr, Certificated	D3563000C
CG16K, 0-100 Torr, Certificated	D3563100C
CG16K, 0-40 Torr, Certificated	D3563200C
CG16K, 0-20 Torr, Certificated	D3563300C

## Technical Data

Range	0-1040 mbar, 0-760 Torr 0-125 mbar, 0.100 Torr 0-50 mbar, 0-40 Torr 0-25 mbar, 0-20 Torr
Accuracy	$\pm 2\%$ of full scale deflection
Maximum applied pressure	
25 mbar version	1 bar absolute, 0 bar gauge
Other versions	2 bar absolute, 1 bar gauge
Weight	1 kg
Vacuum connection	NW16 Flange
Accessories supplied	Clamp and studs for panel mounting